

FRONT ELEVATION

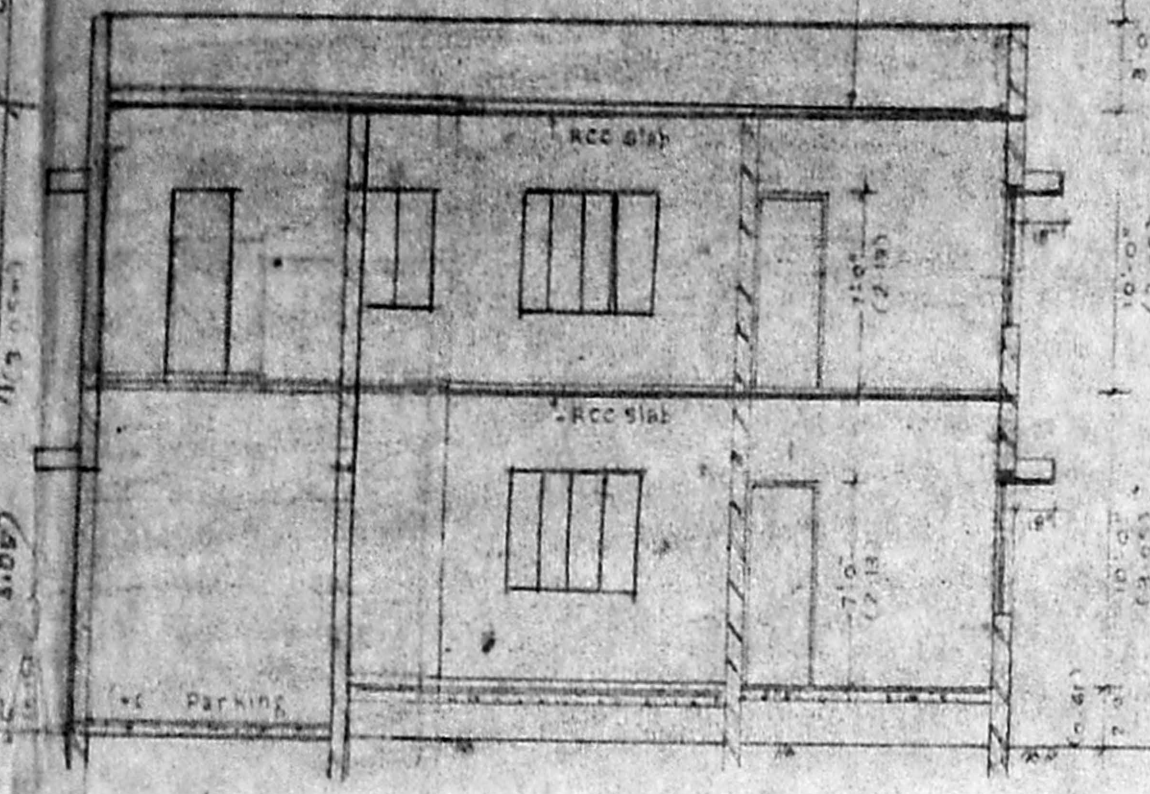

SECTION ON AA

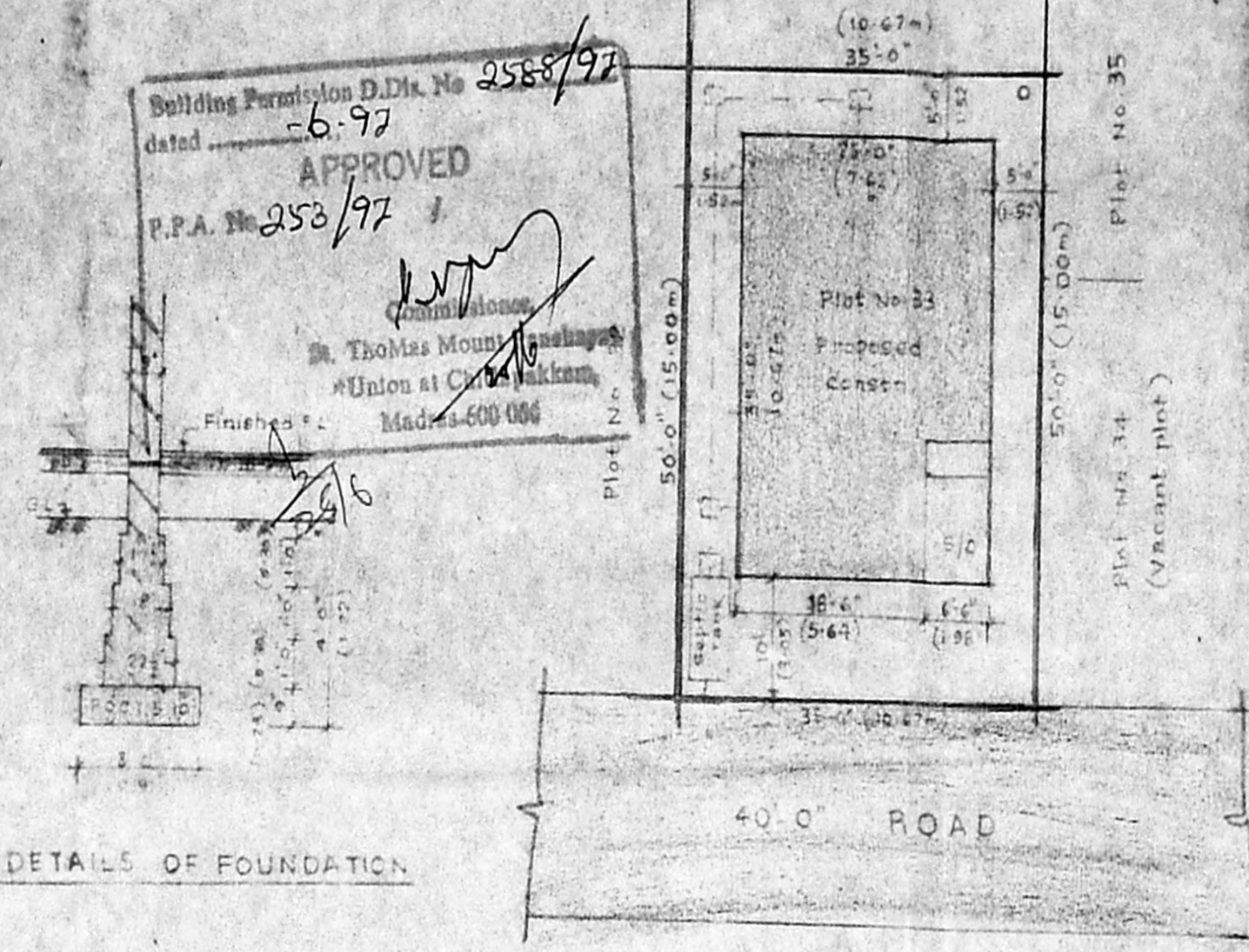

DETAILS OF FOUNDATION

Building Permission D.D. No. 2558/97
 dated 6.9.97
 APPROVED
 P.P.A. No. 253/97
 Dr. Theobald Mouni
 Union at Chembakkam
 Madras - 600 008

SITE PLAN
 Scale: 1" = 100'

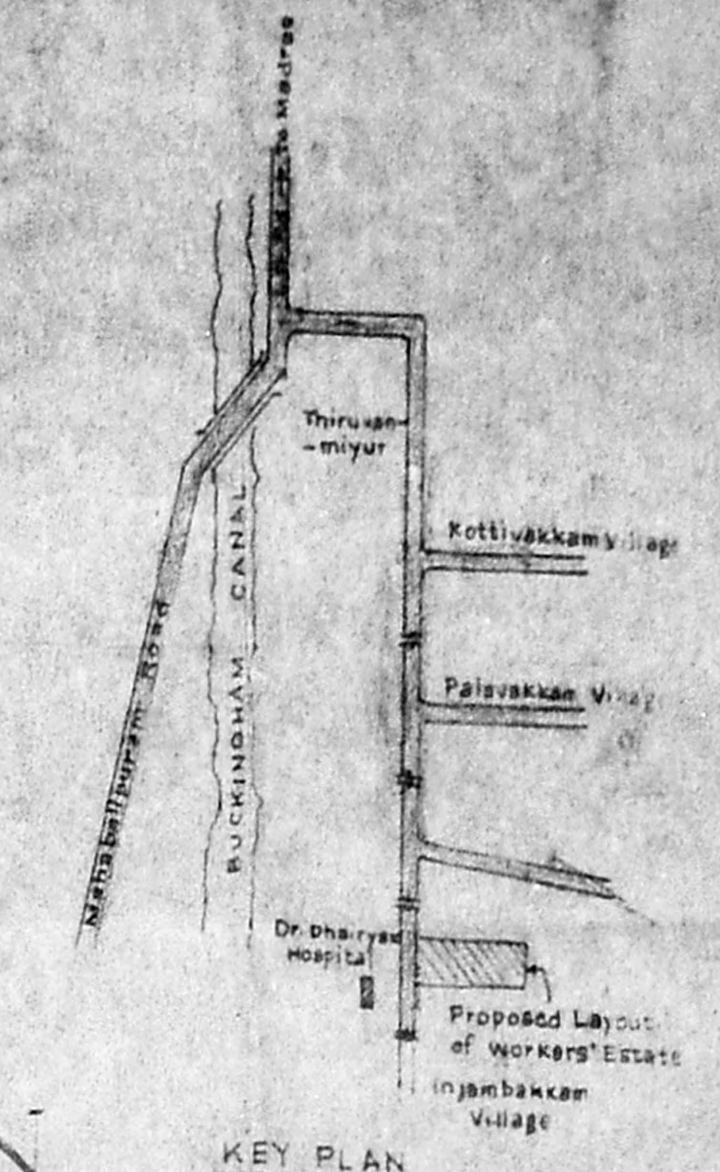

KEY PLAN

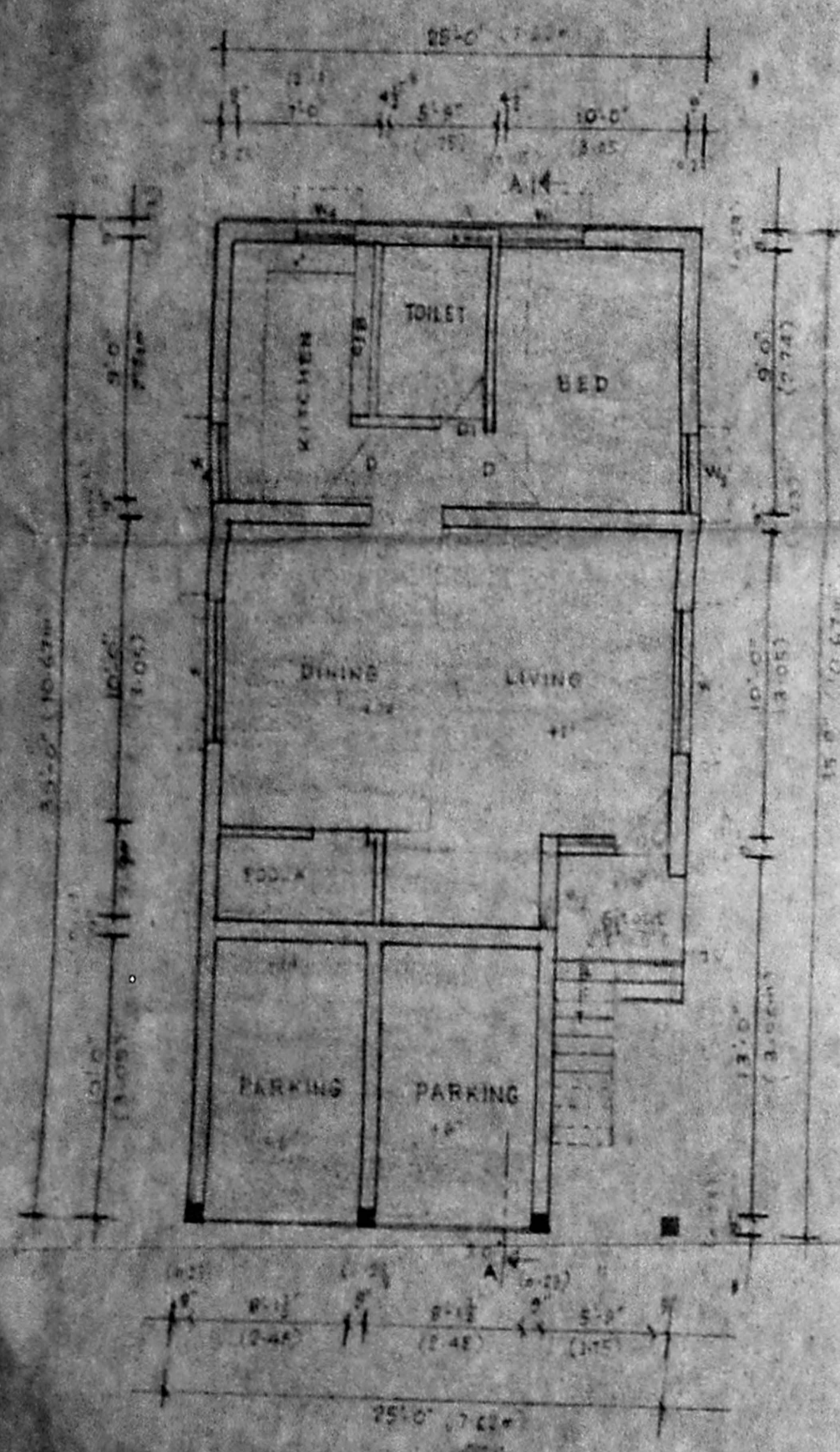

GROUND FLOOR PLAN

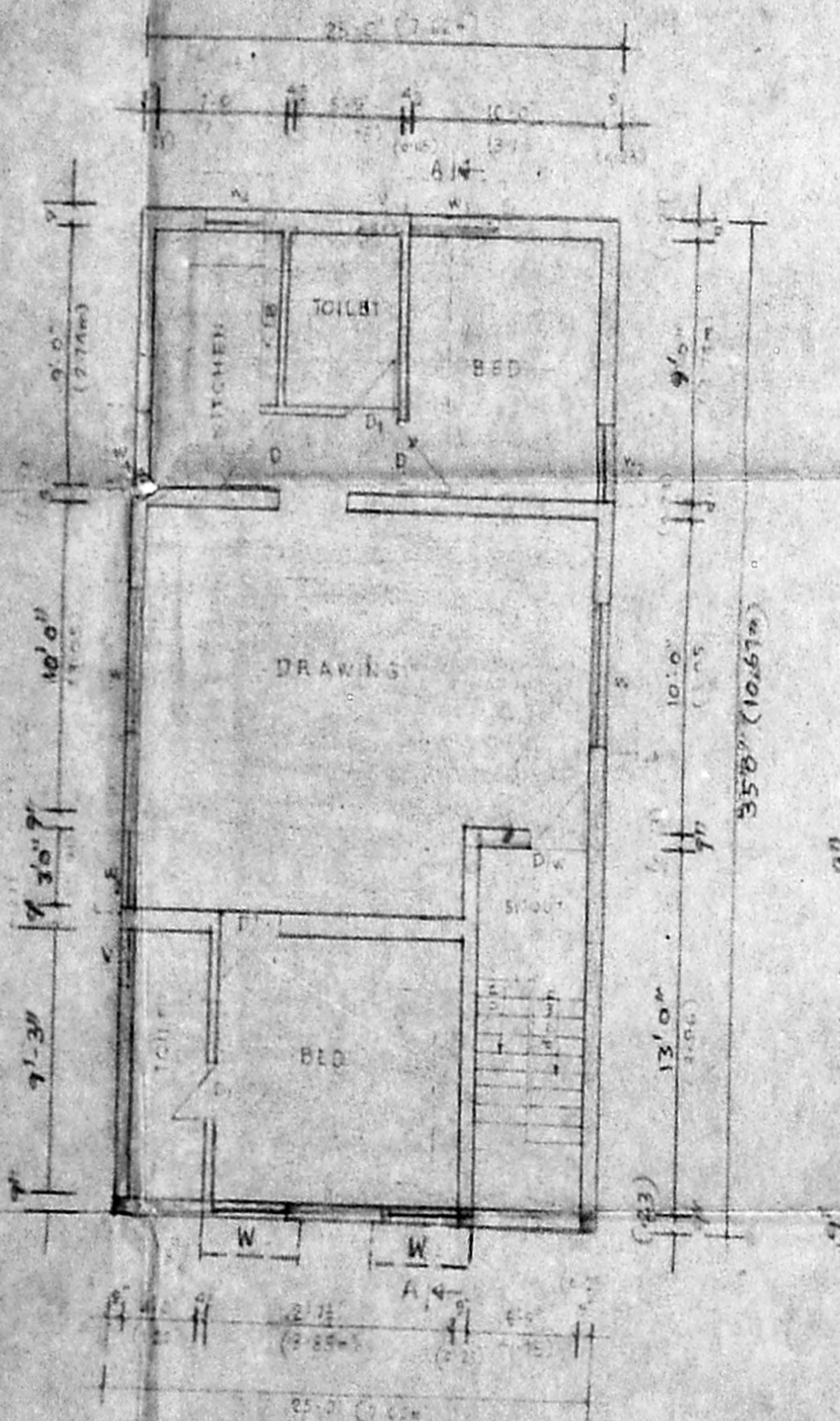

FIRST FLOOR PLAN

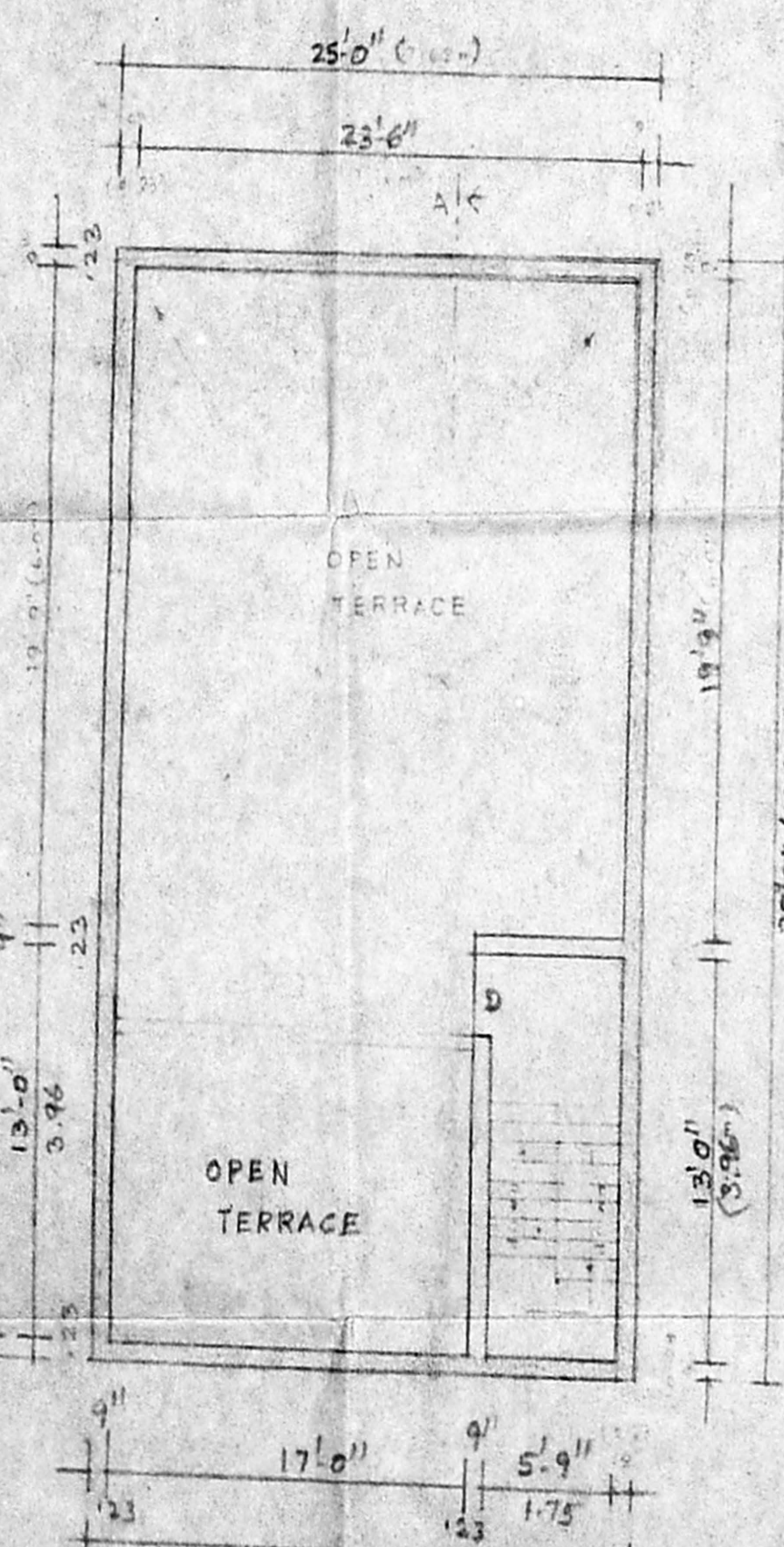

TERRACE PLAN

A/24233/173/97
 Planning Permit No.
 APPROVED
 SUBJECT TO THE CONDITIONS IN
 THIS OFFICE ORDER.
 No. A/17821/97 dated 22.4.97
 FOR MEMBER SECRETARY
 MADRAS METROPOLITAN
 DEVELOPMENT AUTHORITY
 MADRAS - 600 008.

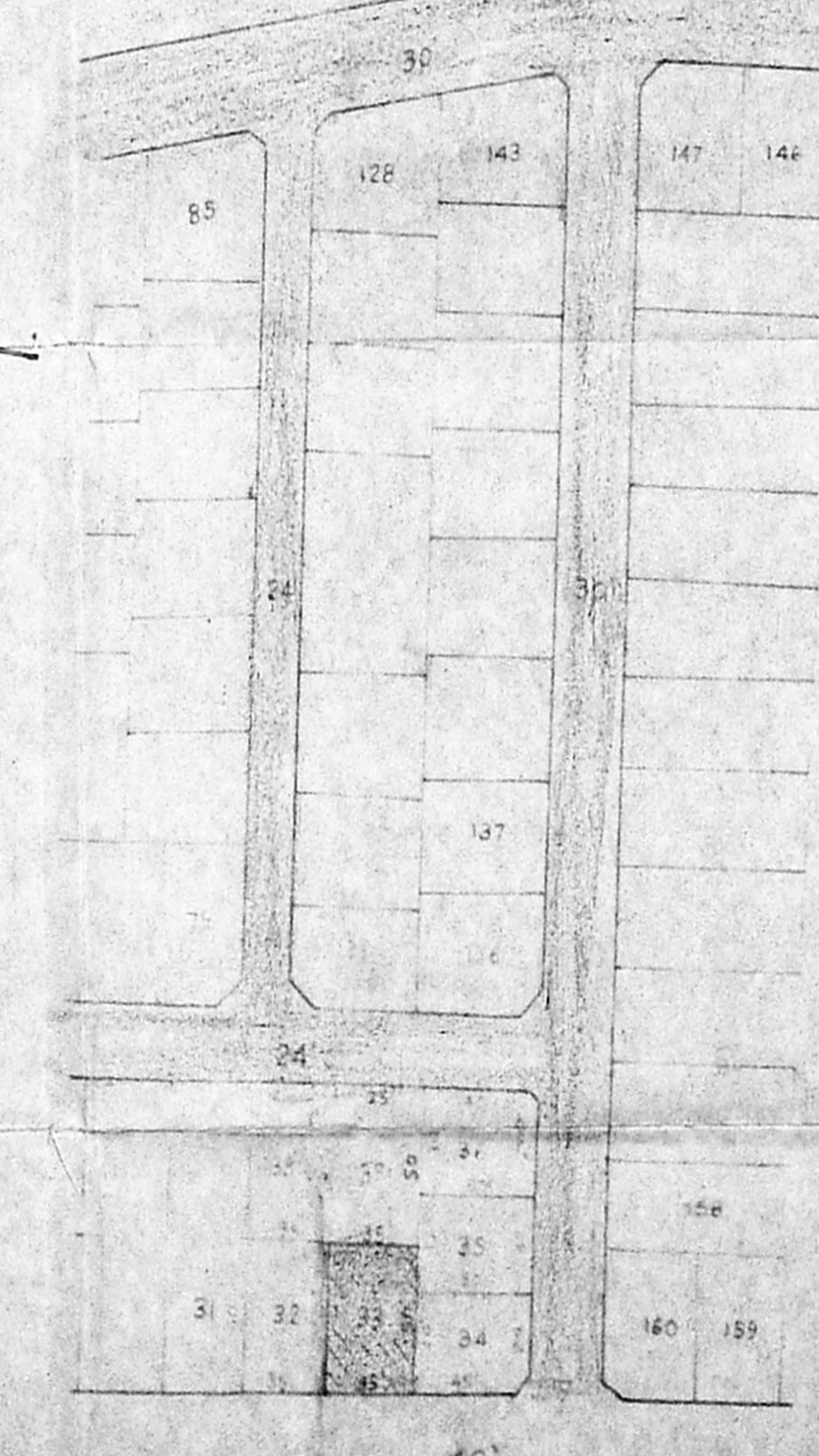

LAYOUT PLAN
 Scale: 1" = 66.67'

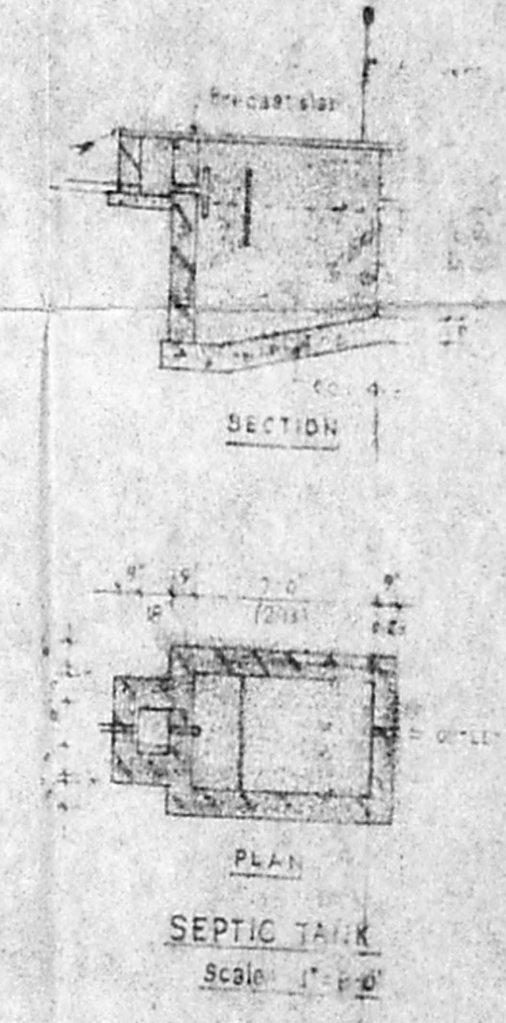

SEPTIC TANK
 Scale: 1" = 1'-0"

SCHEDULE OF JOINERY

S.No	Type	QTY	Size	Method
1	D/W	1	3'-0" x 7'-0"	0.91 x 2.13
2	D	1	2'-0" x 4'-0"	0.89 x 1.83
3	D1	1	3'-0" x 7'-0"	0.91 x 2.13
4	W	1	2'-0" x 7'-0"	0.89 x 2.13
5	W1	1	4'-0" x 4'-0"	1.83 x 1.83
6	W2	1	4'-0" x 4'-0"	1.37 x 1.83
7	W3	1	3'-0" x 4'-0"	0.91 x 1.83
8	W4	1	3'-4" x 4'-0"	1.03 x 1.83
9	V	1	3'-0" x 8'-0"	0.91 x 2.13

SCALE: 1 inch = 8 ft (1:100)

SPECIFICATIONS

- Foundation shall be of traditional spread footing with BW in CM 1:5
- Superstructure shall be of BW in CM 1:5
- Flooring shall be of mosaic tiles flooring laid over a bed of cc. 5 cm of 15 cm thick
- Roofing shall be of RCC 12% of 12 cm thick
- Terracing shall be of brick jell lime conc. laid to slope with one course of pressed brick tiles
- Wood work shall be of best available country wood

Proposed construction	Proposed site
Road	
Area of proposed site	1750 sqft (162.24 m ²)
Ground Floor plinth area	875 sqft (81.34 m ²)
First Floor plinth area	875 sqft (81.34 m ²)
F.F.C.	1:100
Plot coverage	50%

PLAN SHOWING PROPOSED CONSTRUCTION OF DWELLING HOUSE AT PLOT No. 33, WORKERS' ESTATE, S No. 95 PART OF NILANGARAI VILLAGE No. 145 SAIDAPET TALUK, CHENGAI MGR Dist.

D. SENTHILATHIBAN, SE., M.B.E.
 CHARTERED ENGINEER & CONSULTANT
 LICENSED SURVEYOR CLASS - I NO. 187

Signature of owner

Corporation of Madras - Andampattu Township
 No. A/ 235, Block 3 - St. off. S.H.M.T.M. & Kambur Colony, (Opposite Neshamam Anaparthi Near Bus Depot) Villavakkam Madras - 600 008
 Ph: 6262288 Fax: 6265592

A/24233/173/97
 Planning Permit No.
APPROVED
 SUBJECT TO THE CONDITIONS IN THIS OFFICE LETTER.
 No. A/1/38/1/97 Date 23/4/97
 Sd/XXXXXX
 FOR MEMBER SECRETARY
 CHENNAI METROPOLITAN
 DEVELOPMENT AUTHORITY
 CHENNAI - 600 008.

A/27452/39/2000
 Planning Permit No.
RENEWED
 SUBJECT TO THE CONDITIONS IN THIS OFFICE LETTER.
 No. A/2/10642/2000-2-2001
 Sd/XXXXXX
 FOR MEMBER SECRETARY
 CHENNAI METROPOLITAN
 DEVELOPMENT AUTHORITY
 CHENNAI - 600 008.

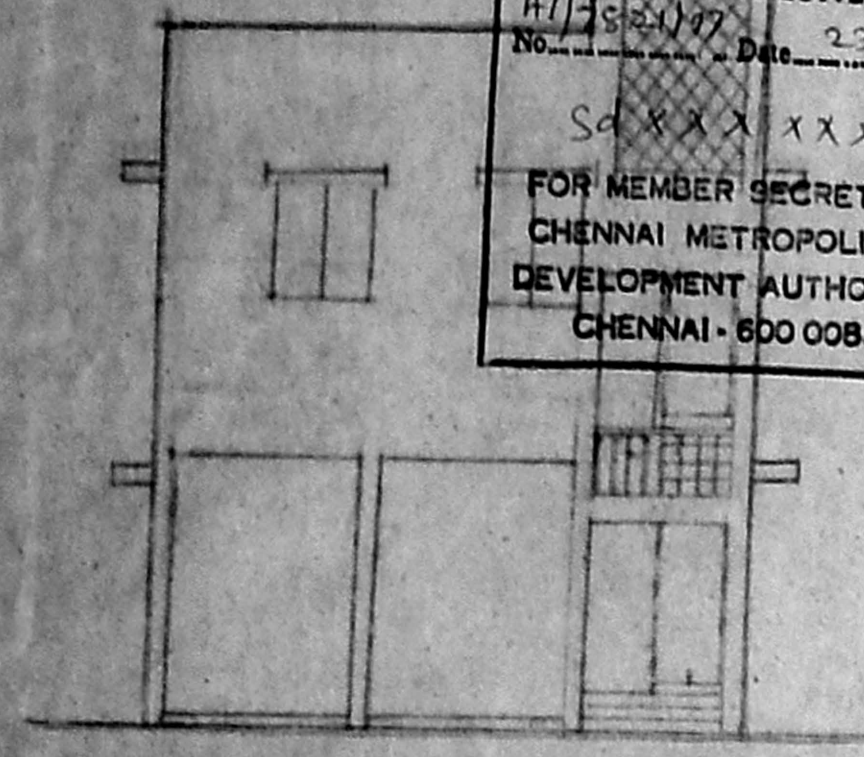

FRONT ELEVATION

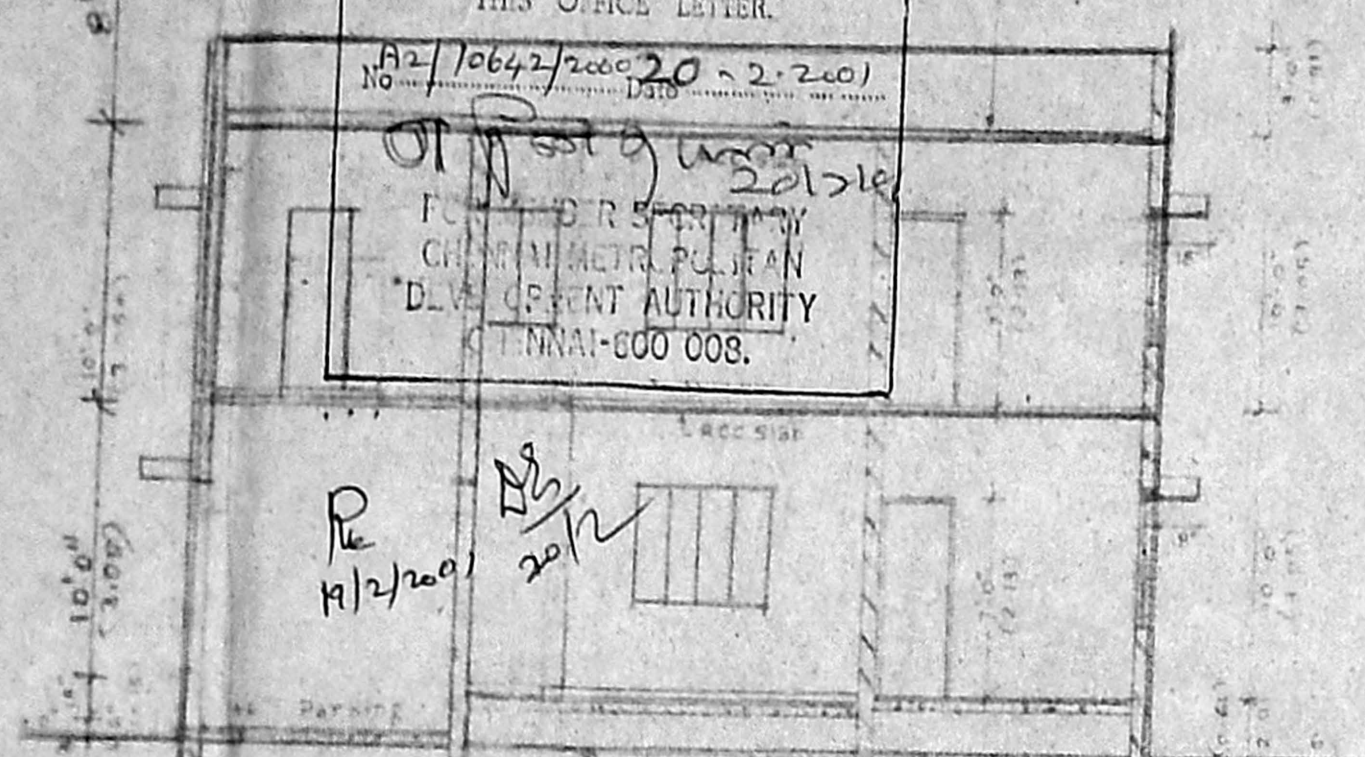

SECTION ON AA

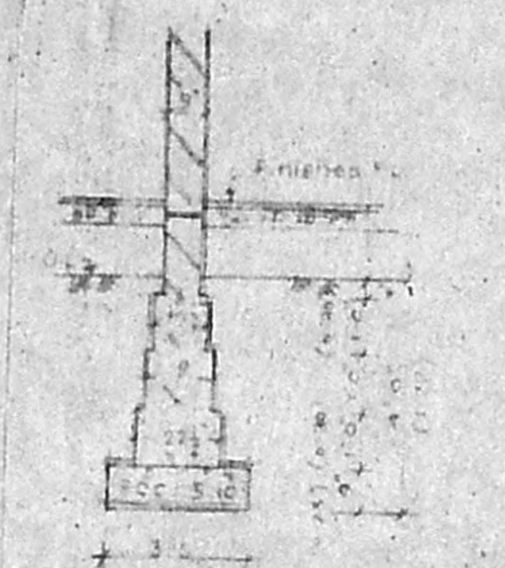

DETAILS OF FOUNDATION

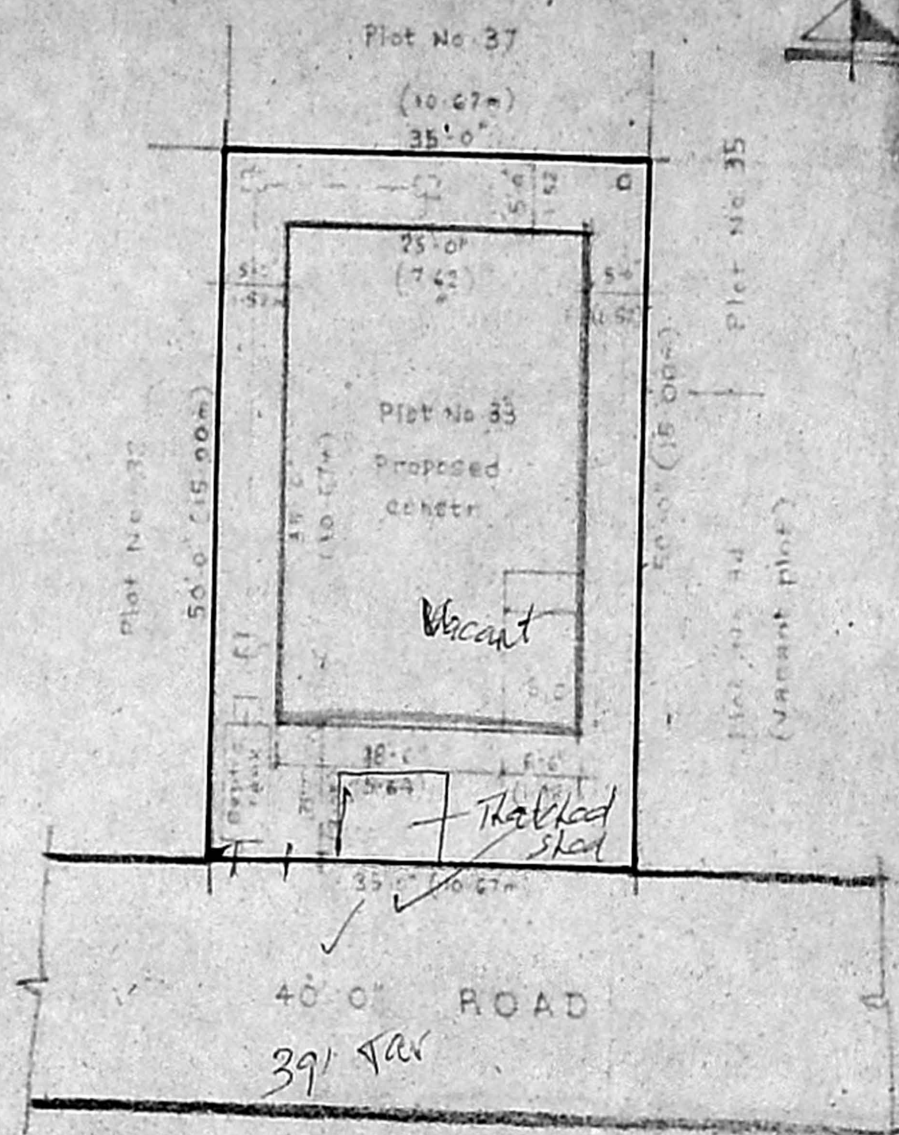

SITE PLAN
 Scale: 1" = 16'0"

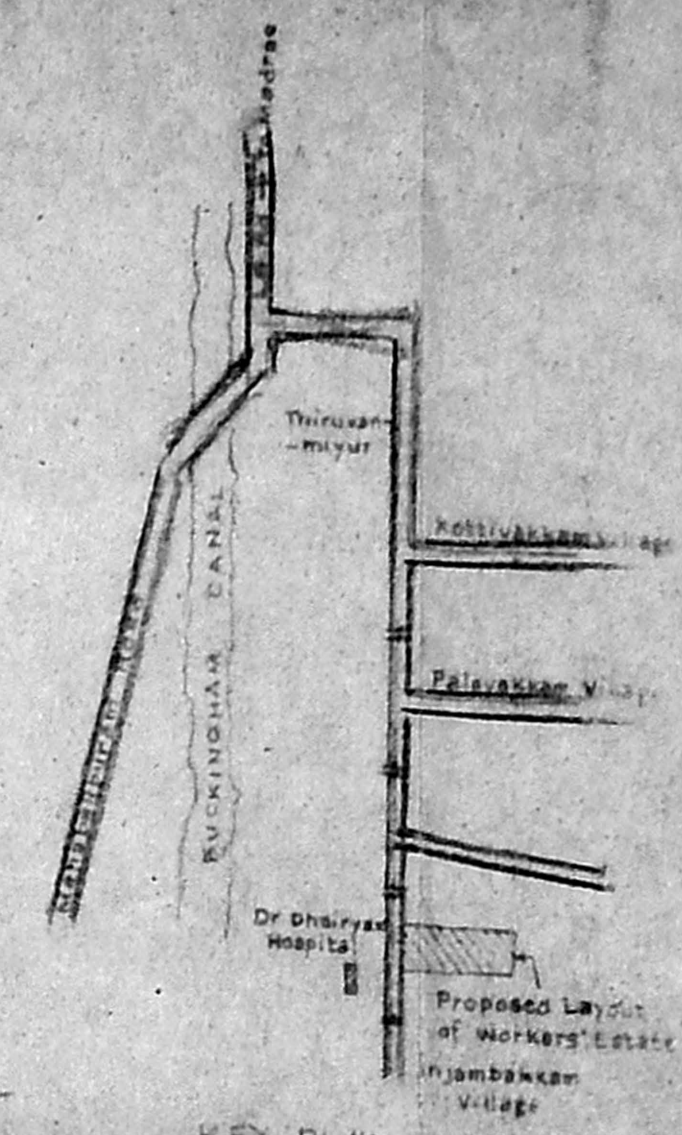

KEY PLAN

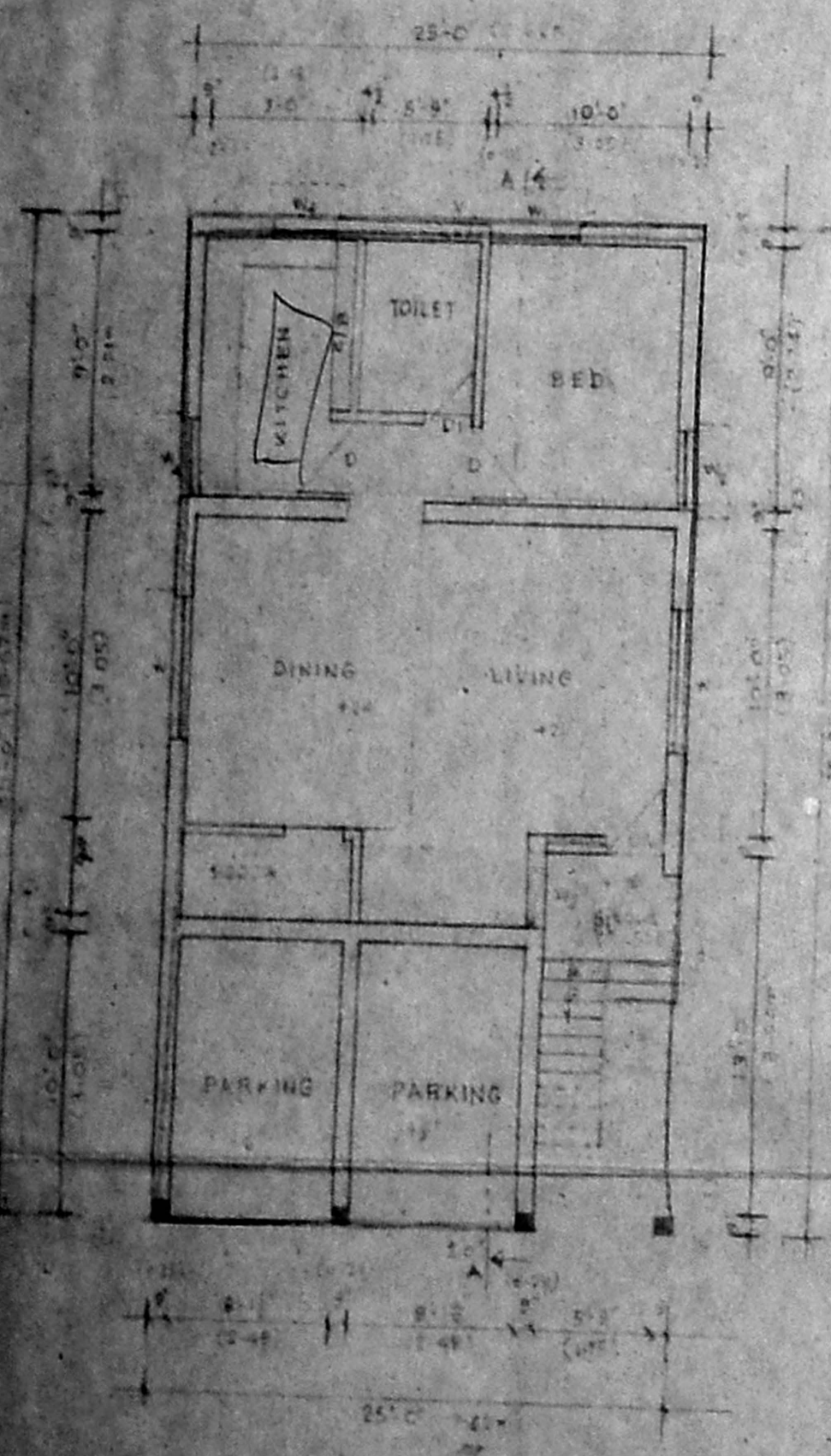

GROUND FLOOR PLAN

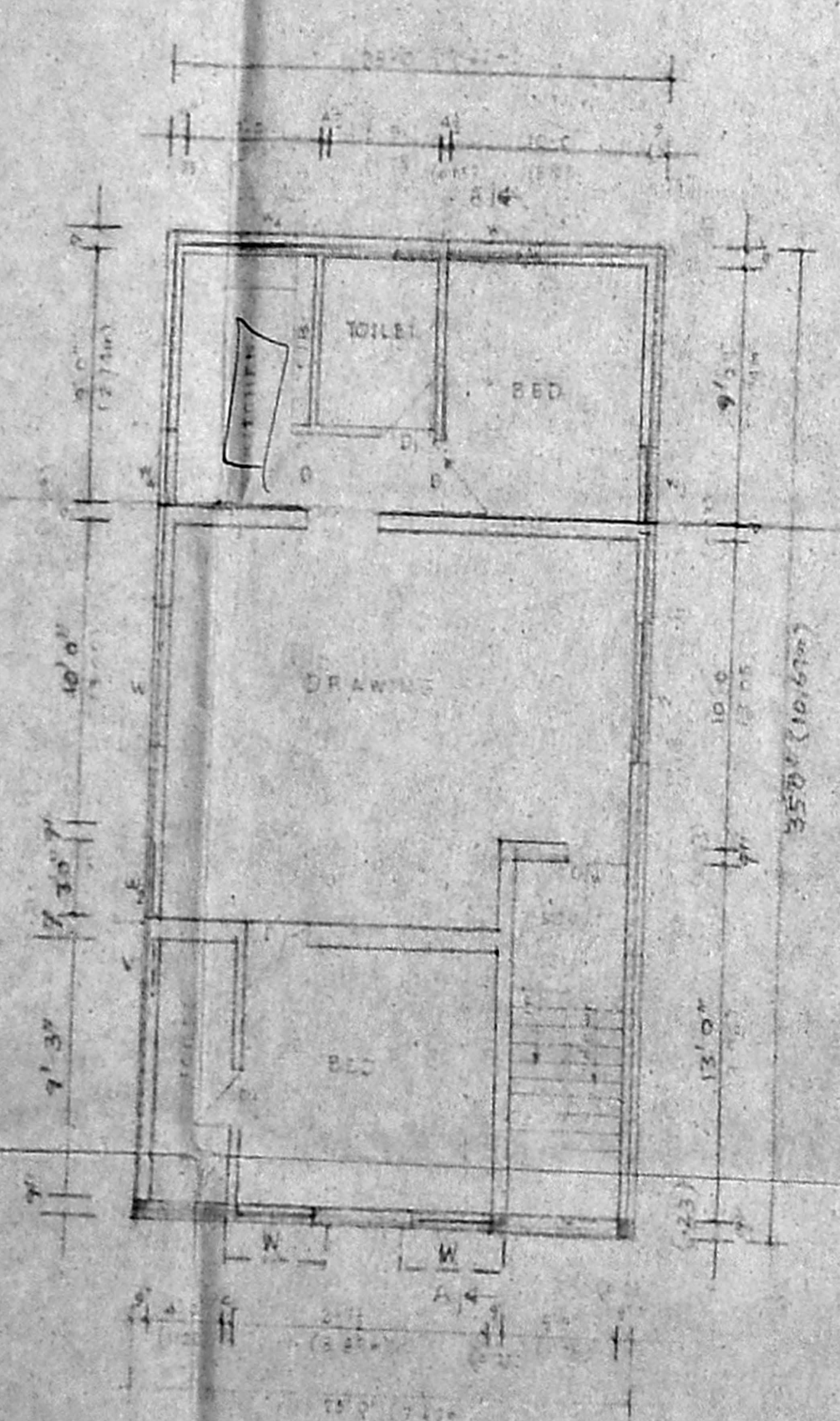

FIRST FLOOR PLAN

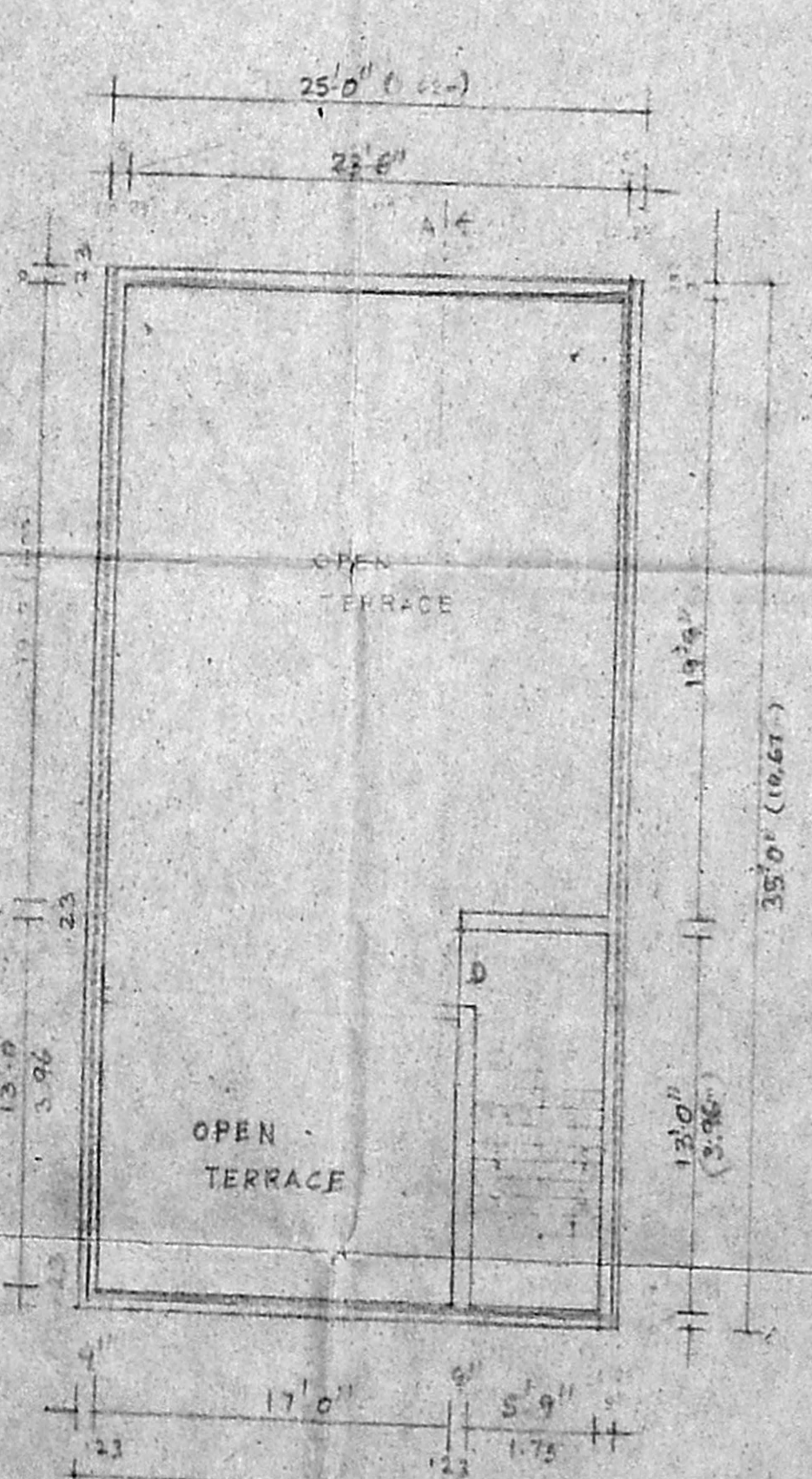

TERRACE PLAN

12/6/2000
 Vacant

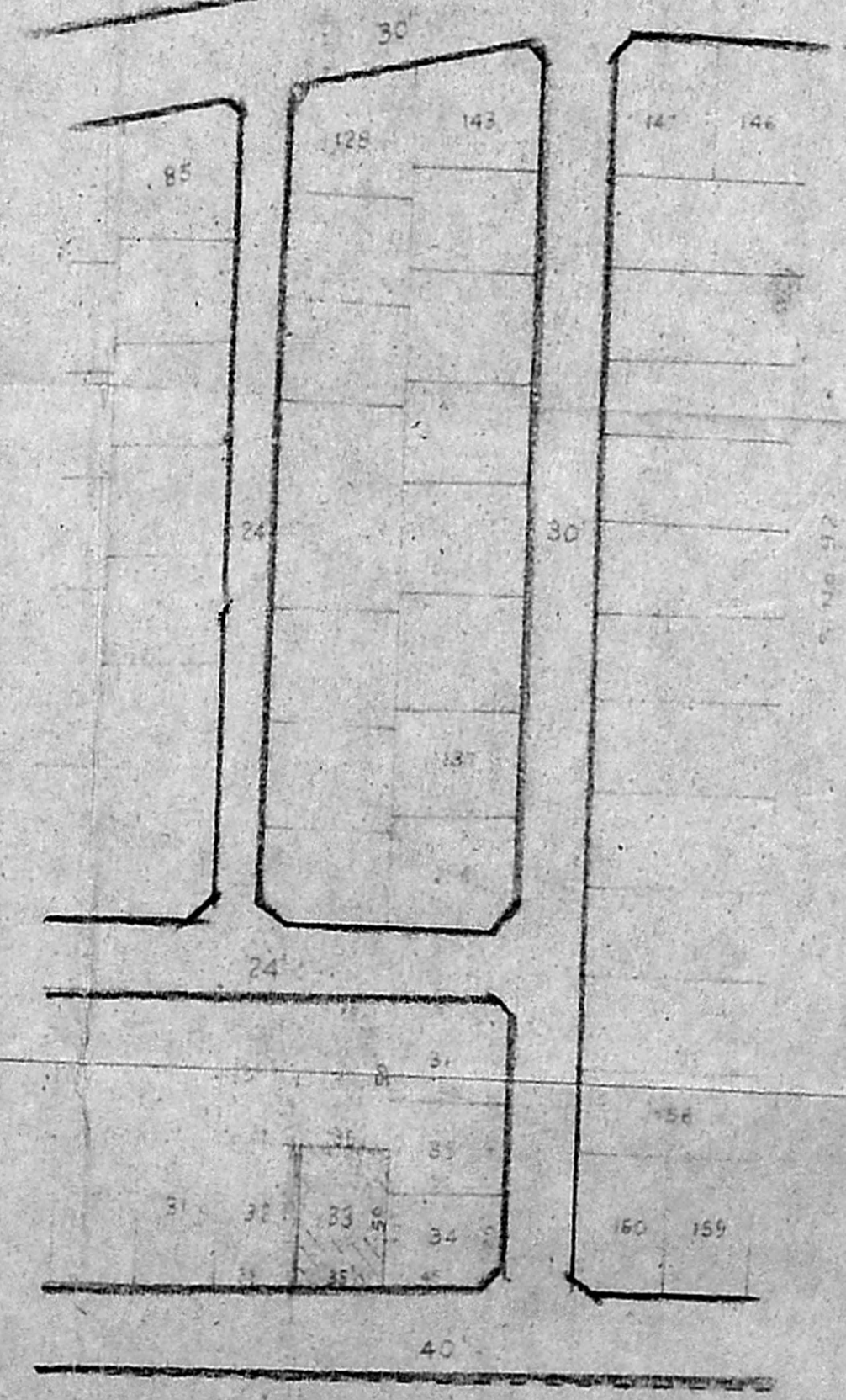

LAYOUT PLAN

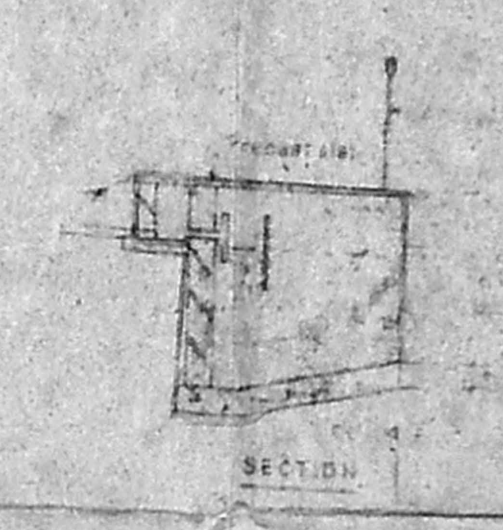

SECTION

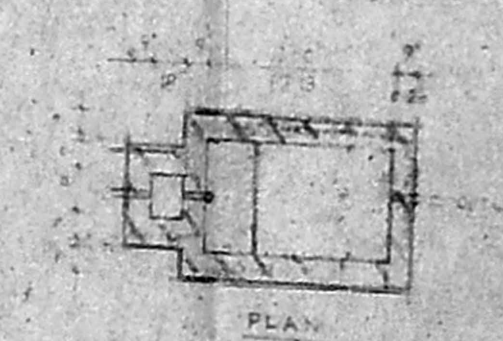

SEPTIC TANK
 Scale: 1" = 4'0"

SCHEDULE OF JOINERY

S.No	Type	DETAILS	Unit	Quantity
1	Dr	Panelled Door / glazed window	3'-0" x 7'-0"	0-91 x 2-15
2	D	Panelled Door	2'-9" x 4'-6"	0-88 x 1-37
3	D	do	5'-0" x 7'-0"	0-91 x 2-15
4	W	Glazed Window	2'-6" x 7'-0"	0-76 x 2-18
5	W	do	4'-6" x 4'-6"	0-37 x 1-37
6	W	do	3'-0" x 4'-6"	0-61 x 1-37
7	W	do	3'-4" x 4'-6"	1-03 x 1-37
8	W	do	3'-0" x 3'-0"	0-91 x 0-91
9	W	Glazed window	2'-6" x 7'-0"	0-76 x 2-18

SPECIFICATIONS

- Foundation shall be of traditional spread footing with 8M in CW 15.
- Superstructure shall be of 8M in CW 15.
- Flooring shall be of mosaic tiles flooring laid over a bed of 20 mm of 1:4:8 concrete.
- Roofing shall be of RCC slab of 120 mm thick.
- Terracing shall be of brick with lime concrete laid to slope with one course of pressed brick tiles.
- Wood work shall be of best available country wood.

Proposed construction

Road	Proposed site
Area of proposed site	1750 sqft (162.24 m ²)
Ground Floor plan	875 sqft (81.34 m ²)
First Floor plan	875 sqft (81.34 m ²)
Plot coverage	50%

PLAN SHOWING PROPOSED CONSTRUCTION OF DWELLING HOUSE AT PLOT No. 33, WORKERS ESTATE, S No. 95 PART OF NILANGARA VILLAGE No. 145 SAIDAPET TALK, CHENNAI MGR DIST.

S. Mantharan
S. MANOHARAN, M. ARCH
 REGISTERED ARCHITECT
 CA/89/12583
 165, Kodambakkam High Road,
 NUNGAMBAKKAM,
 MADRAS-600 034
 Phone: 8272736.

P. Senthilathan
P. SENTHILATHAN, SE., M.S.B.
 CHARTERED ENGINEER & CONSULTANT
 LICENSED SURVEYOR CLASS I NO. 187
 Corporation of Madras, And: Ambastar House,
 Res. A/7, 135, 1 Block 3, St. off: S. N. T. H. &
 Kambur Colony, 100 Feet Nungambakkam
 Ambastar House Box Dupoli, Nungambakkam
 Madras-600 034
 PH: 6262241 FAX: 6265562